

# HOW TO: Attach an EVO seat to *FLEX*pod-HD

## Fitting diagram

Recommended 8 bolt set up

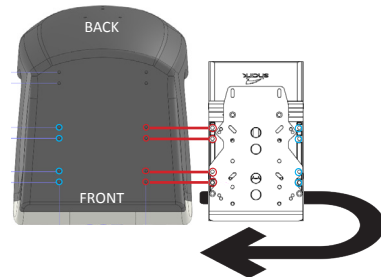

4 bolt set up

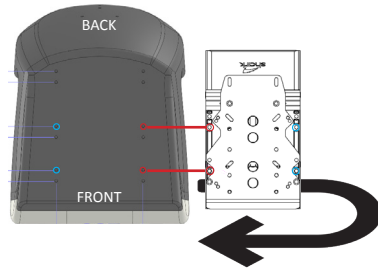

### Shark P/N#:

EVO seat: FGXX0000

*FLEX*pod suspension: PXFXAA00

### HARDWARE SPECIFIC TO PROCESS

- (6) NYLOC NUTS
- (6) M8 STAINLESS WASHERS
- (6) M8 x 30MM HEX HEAD BOLTS

### TOOLS REQUIRED:

13MM SOCKET WRENCH



Scan to follow along  
on YouTube



## A. Remove Bolts from seat and set up

Remove the 6 M8 x 30mm hex head bolts with black washers that are finger tightened to the bottom of the seat. Place the seat on the ground with the threads at the base of the seat facing upwards. If possible, place an object under the seat surface so the threads are horizontal. If there isn't one accessible, lay the seat by the top of the back rest and the end of the seating area to form a triangle with the threads facing you.

## B. Line up and fasten

Use the images in the fitting diagram to help line up the suspension correctly. The 8 bolt set up is preferred. However, if your space requirements need your seat to be moved forwards by one hole, that is possible using the 4 bolt set up. Start by inserting the M8x30mm hex head bolts with black washers into the holes you are fastening to. Loosely finger tighten them all, then with a 13mm socket wrench, fasten all of the bolts. Be sure not to over tighten.